

**JOHN MAST CONST.**  
 257 Haney St  
 Nappanee, IN 46550  
 PH 514.773.3243  
 FX 888.836.3343  
 Thomas@MailJMC.com

**CLIENT:**  
 Mahlon Miller

**TITLE:** New House

DWN BY: TM  
 FILE  
 DATE: 1/9/2014  
 SCALE: AS NOTED  
 JOB NO: 0401

ALL DIMENSIONS MUST BE FIELD VERIFIED BY THE CONTRACTOR. JOHN MAST CONSTRUCTION SHALL NOT BE RESPONSIBLE FOR ANY DIMENSIONAL DISCREPANCIES WHICH HAVE NOT BEEN BROUGHT TO THEIR ATTENTION PRIOR TO CONSTRUCTION.

This drawing and all information contained herein is the property of John Mast Construction and is not to be reproduced without the expressed written permission of John Mast Construction. John Mast Construction assumes no responsibility for unauthorized use.

**JOHN MAST CONSTRUCTION**  
 MR & MRS MAHLON MILLER  
 RESIDENCE  
 2775 6th RD BREMEN IN  
 JOB #0401 3-22/04

DWG NO.

12" CONCRETE WALL  
 TOP OF WALL ELEVATION  
 99'  
 (12' 8" HIGH WALL)  
 - 4" BLOCK BRICK LEDGE 24"  
 HIGH  
 - BOTTOM OF WALL 3'  
 BELOW GRADE

10" WALL WITH 4" BRICK  
 LEDGE  
 TOP OF WALL ELEVATION  
 88'11 1/2"  
 (32" HIGH WALL)  
 - BOTTOM OF WALL 3'  
 BELOW GRADE

- BOTTOM OF WALL 3'  
 BELOW GRADE

8" CONCRETE WALL  
 TOP OF WALL  
 ELEVATION 98'7  
 (9'11 1/2" HIGH  
 WALL)  
 - 2 DOOR OPENINGS

12" WALL WITH DOUBLE 4"  
 BRICK LEDGE  
 8" DEEP OUTSIDE 14" DEEP  
 INSIDE  
 TOP OF WALL ELEVATION 99'9  
 1/2"  
 (11' 2" HIGH WALL)

12" CONCRETE WALL  
 TOP OF WALL ELEVATION  
 98'7 1/2"  
 (10' HIGH WALL)

12" WALL  
 TOP OF WALL  
 ELEVATION 98'7"  
 (9'11 1/2" HIGH WALL)

JOHN MAST  
 CONSTRUCTION  
 MR & MRS MAHLON MILL  
 RESIDENCE  
 2775 6th RD BREMEN IN  
 JOB #0401 3-22/04

**JOHN MAST CONST.**  
 257 Haney St  
 Nappanee, IN 46550  
 PH 514.773.3243  
 FX 888.836.3343  
 Thomas@MailJMC.com

**CLIENT:**  
 Mahlon Miller

**TITLE:** New  
 House

DWN BY: TM

FILE

DATE: 1/9/2014

SCALE: AS NOTED

JOB NO: 0401

ALL DIMENSIONS MUST BE FIELD  
 VERIFIED BY THE CONTRACTOR  
 JOHN MAST  
 CONSTRUCTION SHALL NOT BE  
 RESPONSIBLE FOR ANY DIMENSIONAL  
 DISCREPANCIES WHICH HAVE NOT BEEN  
 BROUGHT TO THEIR ATTENTION PRIOR  
 TO CONSTRUCTION.

This drawing and all information contained  
 herein is the property of John Mast  
 Construction and is not to be reproduced  
 without the expressed written permission of  
 John Mast Construction. John Mast  
 Construction assumes no responsibility for  
 unauthorized use.

**ELEVATIONS**

DWG NO.

TE WALL  
 ILL

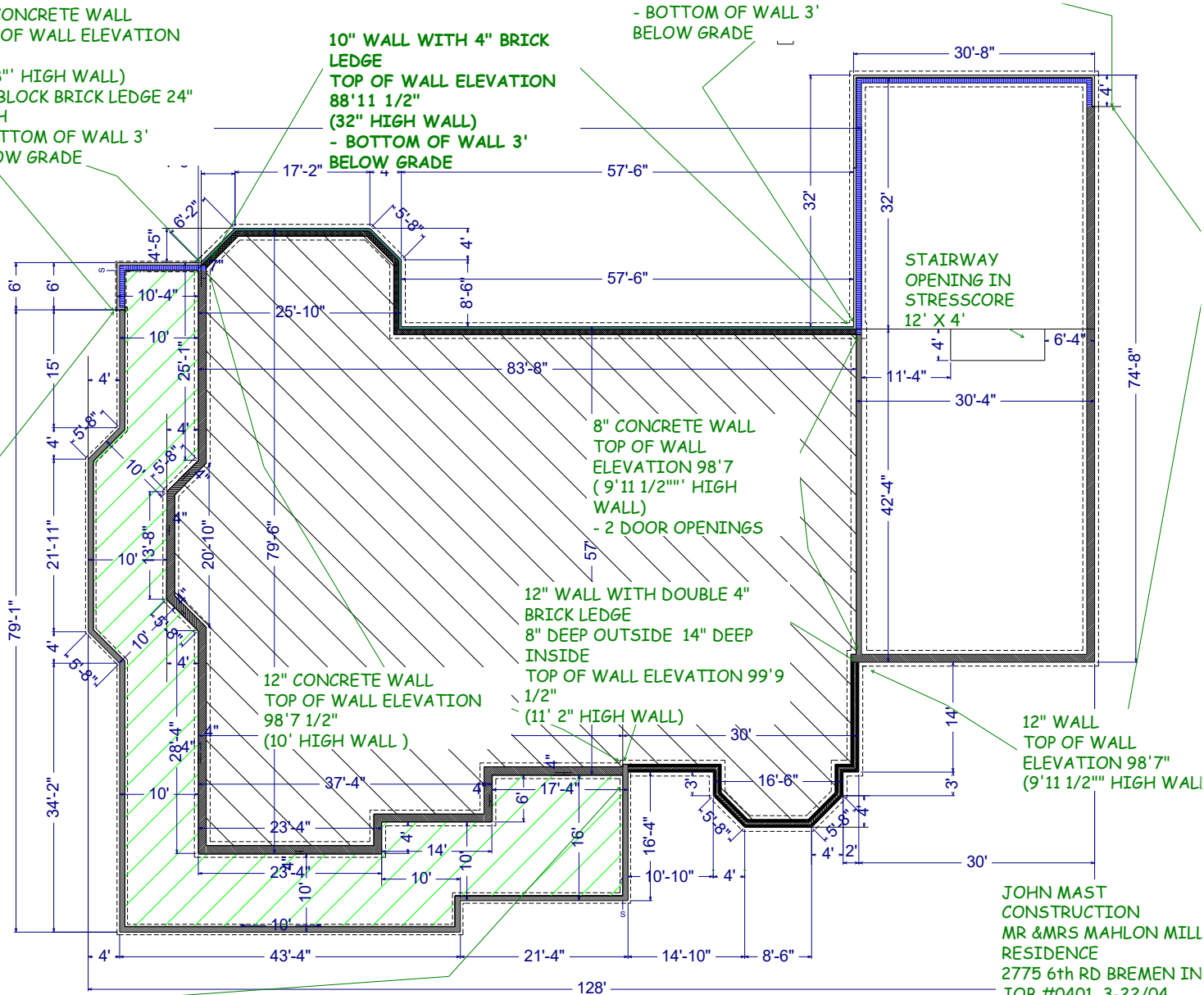

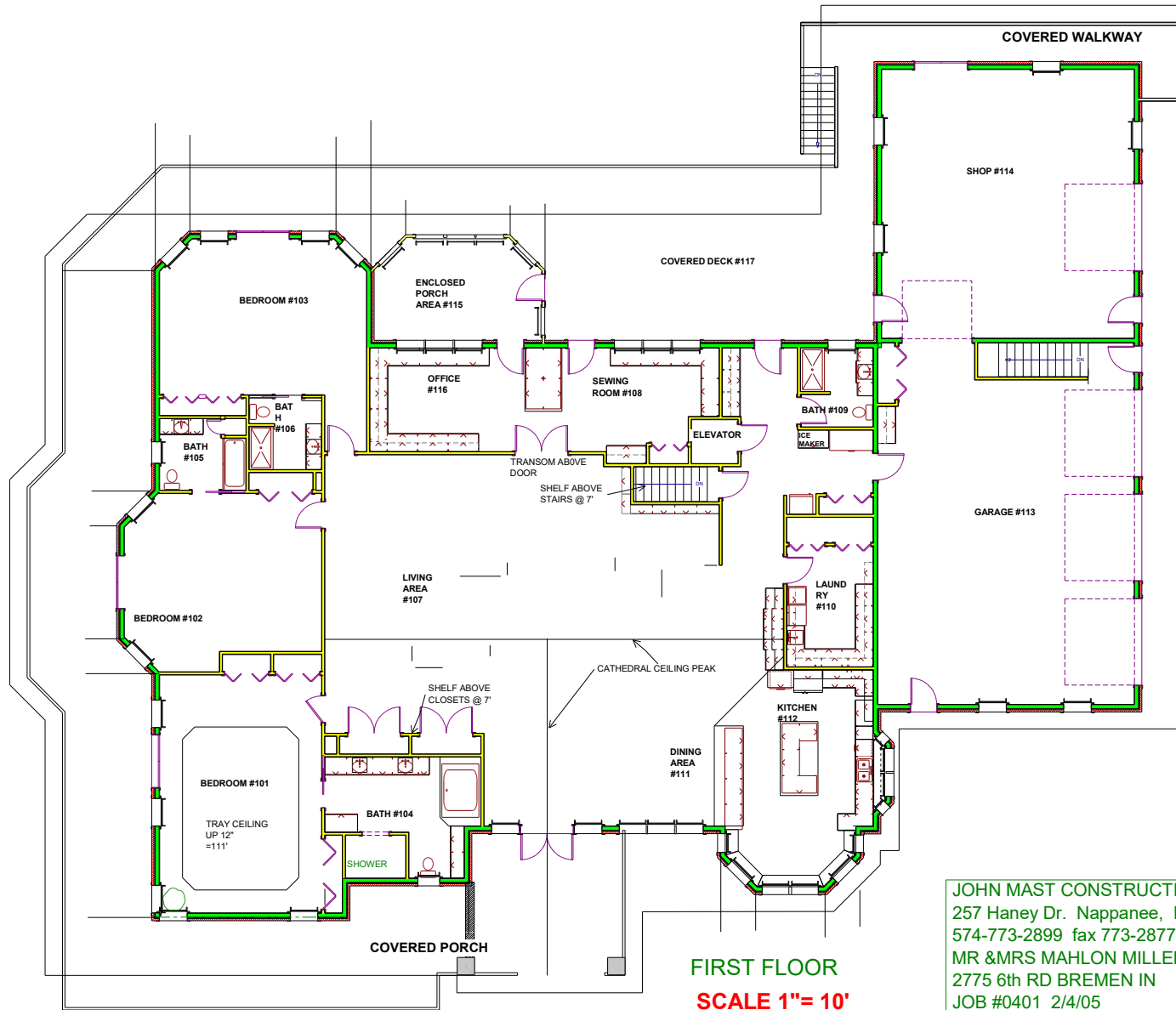

**FIRST FLOOR**  
**SCALE 1" = 10'**

**JOHN MAST CONST.**  
 257 Haney St  
 Nappanee, IN 46550  
 PH 574.773.3243  
 FX 888.836.3343  
 Thomas@MailJMC.com

**CLIENT:**  
**Mahlon Miller**

**TITLE:** New House

DWN BY: TM

FILE LAYERS ON

101

DATE 10/29/2014

101

SCALE: AS NOTED

JOB NO: 0401

ALL DIMENSIONS MUST BE FIELD VERIFIED BY THE CONTRACTOR. JOHN MAST CONSTRUCTION SHALL NOT BE RESPONSIBLE FOR ANY DIMENSIONAL DISCREPANCIES WHICH HAVE NOT BEEN BROUGHT TO THEIR ATTENTION PRIOR TO CONSTRUCTION.

This drawing and all information contained herein is the property of John Mast Construction and is not to be reproduced without the expressed written permission of John Mast Construction. John Mast Construction assumes no responsibility for unauthorized use.

**JOHN MAST CONSTRUCTION**  
 257 Haney Dr. Nappanee, IN 46550  
 574-773-2899 fax 773-2877  
**MR & MRS MAHLON MILLER RESIDENCE**  
 2775 6th RD BREMEN IN  
 JOB #0401 2/4/05

DWG NO.

1