

Van Buren Twp.  
Kosciusko County

# Dewart Lake & Channel Front Property

## AUCTION

Directions: East of St. Rd. 15 on 900 N to 300 E, go south to Defreeze Rd., then east to D18 Lane, follow to:

**104 EMS D 18C Lane • Syracuse, IN 46567**

Note: Property surrounds this address.

### Saturday, September 14, 2024

### Starting at 10:00 AM

Tract 1  
**8.82  
ACRES**

This is a very unique property located on Dewart Lake.

**Unlimited possibilities!**

Presently channel access. Potential building site!  
Auction Held On Site. **INSPECTION ANYTIME!**

Tract 1 Owner: **Linda Kovach**

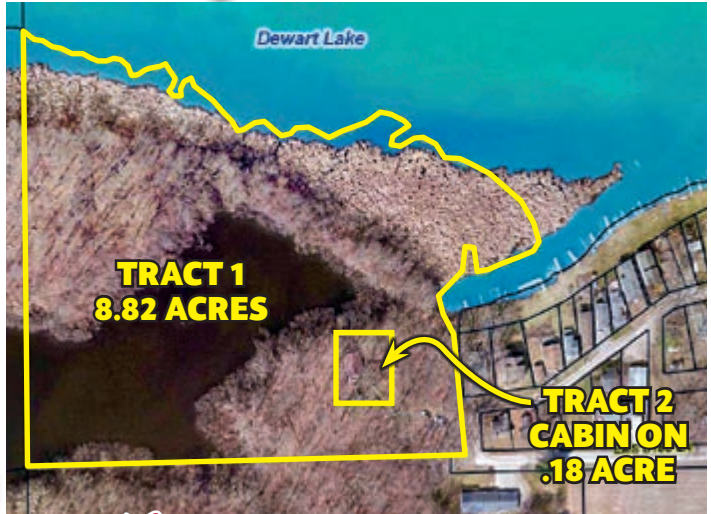

Tract 2

**.18 ACRE  
with Cabin**

**104 EMS D18C Lane • Syracuse, IN**

736 sq. ft. cabin with one bedroom, bath, living area, lake view. Very secluded. Potential building spot or use cabin for a getaway. Easement access to house.

Preview 2 hours prior to auction or by appointment.

Tract 2 Owner: **Eric Leer**



#### REAL ESTATE TERMS & CONDITIONS

**DOWN PAYMENT:** 5% down payment on the day of the auction with the balance in cash at closing. The down payment may be made in the form of cash, cashier's check, personal check or corporate check. Your bidding is not conditional upon financing, so be sure you have arranged financing, if needed, and are capable of paying cash at closing.

Any announcements made day of the sale take precedence over printed matter.

5% Buyer's Premium

**ACCEPTANCE OF BID PRICES:** All successful bidders will be required to enter into purchase agreements at the auction site immediately following the close of the auction. All final bid prices are subject to approval by the Sellers.



**AUCTIONEER NOTE:** Your bidding is not conditional upon financing, so be sure you have arranged financing if needed. For more information on financing or inspection, contact Hahn Auctioneers, Inc.

# HAHN

[hahnrealtyandauction.com](http://hahnrealtyandauction.com)

AC39800021

Phil Hahn  
(574) 535-3783  
IN Lic. #AU01012967

Jason Hahn  
(574) 536-7682



Brian Wuthrich  
Sale Manager

(574) 268-4940 - Milford, IN

Office (574) 773-8445 • Nappanee, IN